

Power Unit

E House Control Room

Rev	Drawing Change	by	Date
CRITICAL INSPECTION ITEMS DENOTED BY			O
TOLERANCES UNLESS OTHERWISE SPECIFIED			
FRAC. ±0.020	2 PL. DEC. ±0.010	3 PL. DEC. ±0.003	TIR

FIRE SAFETY EQUIPMENT PTY LTD				
Drawn By	Approved By	Title	Drawing No	Rev.
PM		GA Drawing Kalmar Crane	15000	B
Scale	Date			
NA	15.12.22			

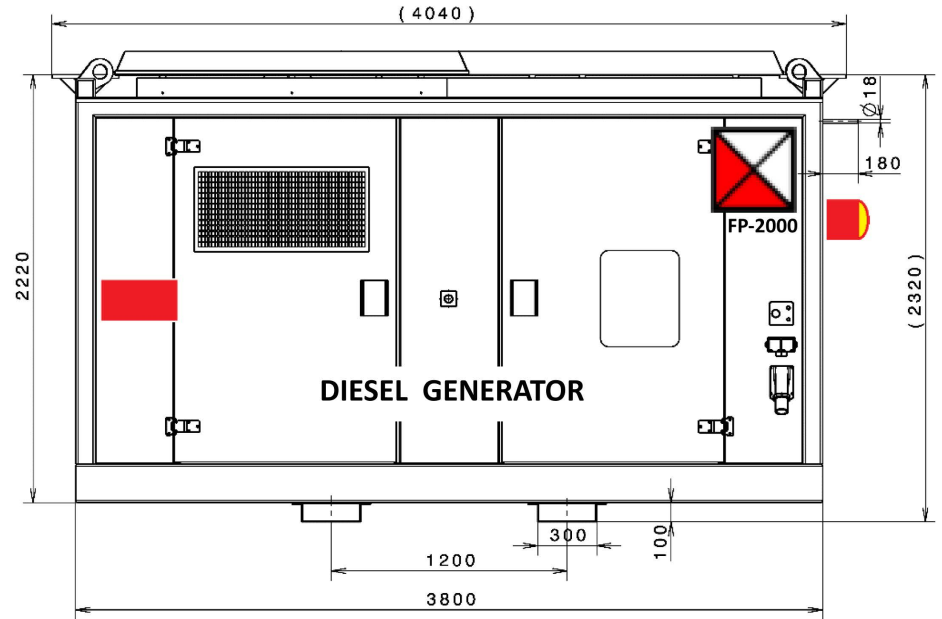
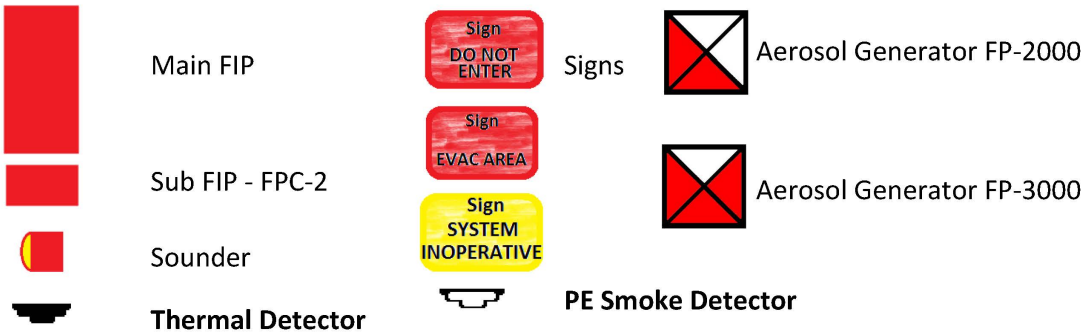
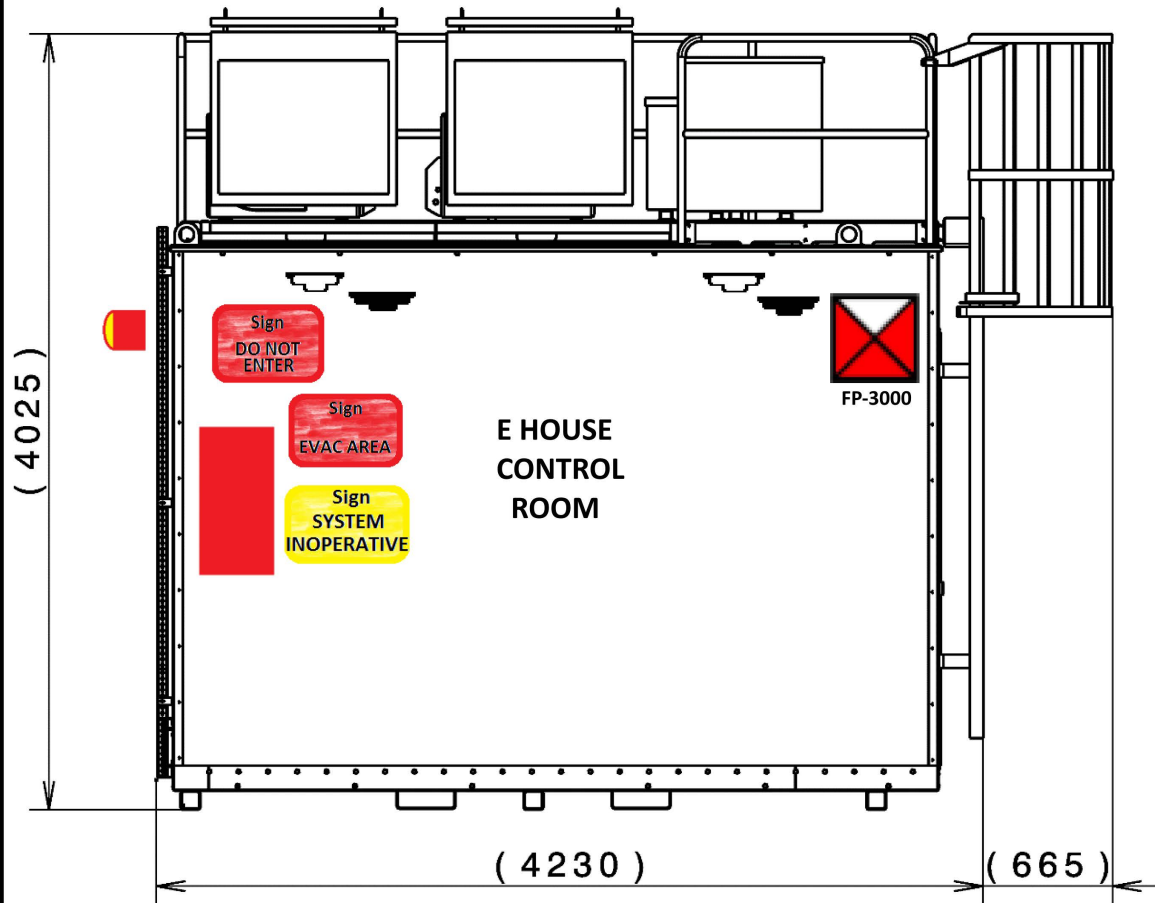

Notes: **AS 4487 INSTALLATION**

- 1 Main FIP located inside EE House 520 x 390 x 130 mm
- 2 Sub FIP Located inside Power House 190 x 135 x 50 mm
- 3 Specific Locations for Components to be identified.
- 4 Power unit requires 1 x FP-3000 aerosol generator
- 5 EE House requires 1 x FP-2000 aerosol generator
- 6 240v AC isolated power supply required to Main FIP
- 7 SUB FIP power from Main FIP
- 8 Sign - DO NOT ENTER - mounted on outside of Power Unit
- 9 Sign - EVAC AREA - mounted inside of Power unit
- 10 Sign - SYS INOPERATIVE - mounted outside of Power Unit
- 11 All Cabling - Fire Rated Shielded Class 5 stranded 0.75mm conductor

Rev	Drawing Change	by	Date
CRITICAL INSPECTION ITEMS DENOTED BY			
TOLERANCES UNLESS OTHERWISE SPECIFIED			
FRAC. ±0.020	2 PL. DEC. ±0.010	3 PL. DEC. ±0.003	TIR

FIRE SAFETY EQUIPMENT PTY LTD				
Drawn By	Approved By	Title	Drawing No	Rev.
PM			15015	B
Scale	Date	GA Drawing Kalmar Crane		
NA	15.12.22			