

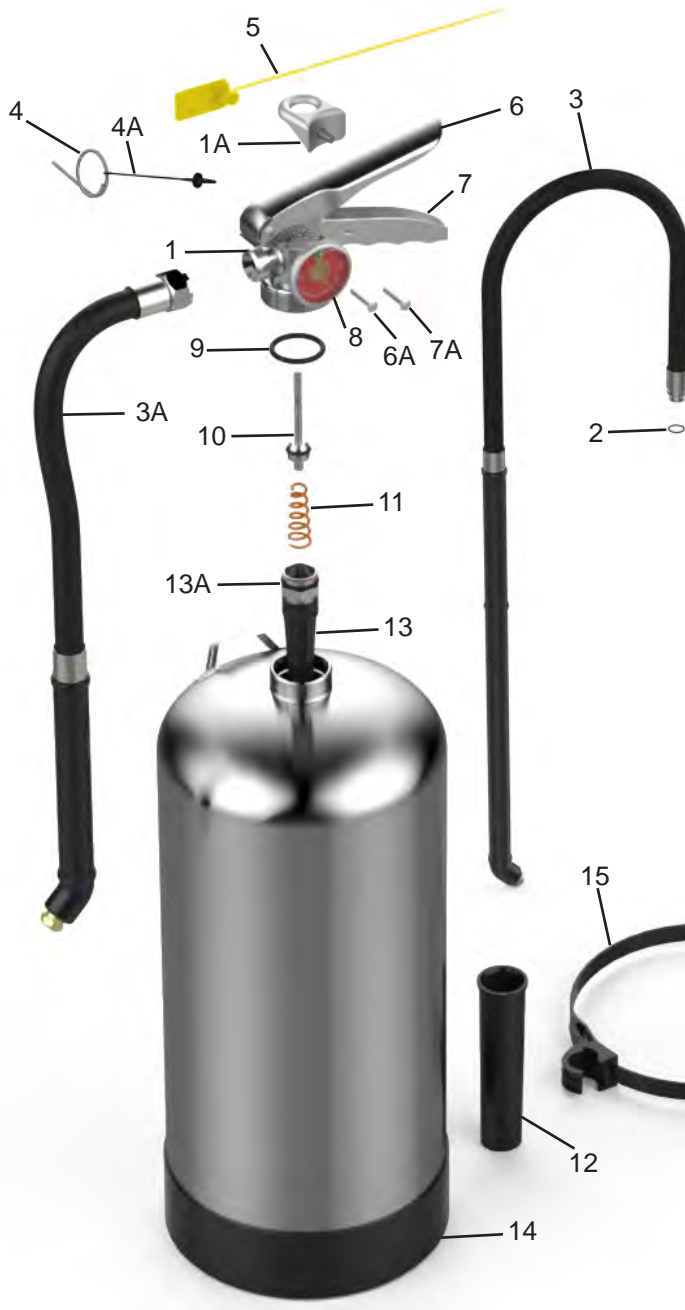

PARTS LIST for 6 Liter and 2½ Gal. Wet Chemical Models

260/B260 / B260CG - 6 Liter
262/B262 / B262CG - 2 1/2 gal.



ITEM NO.	PART NO.	DESCRIPTION
1	14345	Valve Assembly - 260, 262
	14249	Valve Assembly - B260, B260CG, B262, B262CG
1A	14380	Hanger Loop with Screw (OPTIONAL)
2	06978	Hose Gasket (O-Ring) 260, 262
3	14588	Hose & Wand Assembly - 260, 262
3A	16043	Hose & Nozzle Assembly - B260, B260CG
	16101	Hose & Nozzle Assembly - B262, B262CG
4	00160	Ring Pin, Stainless Steel
4A	00532	Chain (Nylon) for Ring Pin
5	01387	Lock Wire Seal (Yellow)
6	07762	Lever & Rivet - ALL MODELS
6A	01563	Rivet Only for Lever
7	09020	Handle & Rivets - ALL MODELS
7A	01564	Rivets Only for Handle (2 Required)
8	17420	Gauge - 100 PSI (S/S Tube) and Thread
9	05240	Collar O-Ring
10	14878	Valve Stem Assembly
11	00383	Spring
12	02595	Fill Tube
13	16266	Downtube/Retainer Ass'y - 260, B260, B260CG
	16267	Downtube/Retainer Ass'y - 262, B262, B262CG
13A	05690	O-Ring Downtube / Retainer
14	03109	Foot Stand (Black)
15	14776	Strap & Clip Ass'y [Black Plastic - 3/8"]
16	14669	Placard (English/Spanish)
	15874	Placard (English/French)
17	21777	Rubber Footstand 7"
	21854	Rubber Footstand Adhesive (Not Shown)
		ALL BRACKETS - SEE BRACKET PAGE
		ALL FILL & HYDROTEST ADAPTERS - SEE ADAPTERS PAGE
All Valve Assemblies include Valve Body, Gauge, Collar Nut, O-Ring, Lever and Handle		

