

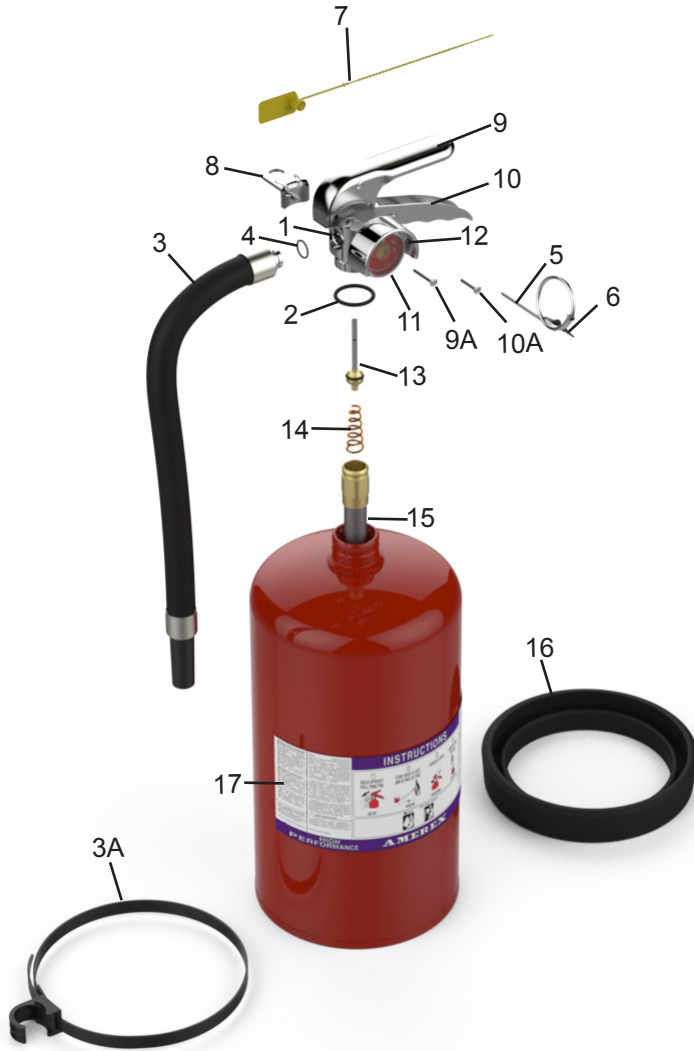

PARTS LIST for 6 Kg - 30 lb. Dry Chemical High Performance Models

564 - 20lb. ABC CF	568 - 30lb. REG FF	589 - 30lb. ABC CF
566 - 20lb. PK FF	569 - 30lb. PK FF	591 - 30lb. PK CF
567 - 30lb. ABC FF	580 - 20lb. PK FF	592 - 6kg. ABC CF
	581 - 20lb. ABC FF	594 - 6kg. ABC FF
	582 - 20lb. REG FF	595 - 6kg. PK FF
	584 - 20lb. PK FF	599 - 6kg. PK CF



ITEM NO.	PART NO.	DESCRIPTION
1	14874	Valve Assembly - (Female Outlet Thread)
2	05240	Collar O-Ring
3*	14785	Hose & Horn Assembly - 594 (.213)
	14791	Hose & Horn Assembly - 595 (.204)
	14788	Hose & Horn Assembly - 580, 581, 582 (.250)
	14790	Hose & Horn Assembly - 592 (.166)
	14794	Hose & Horn Assembly - 599 (.149)
	14787	Hose & Horn Assembly - 564 (.166)
	14786	Hose & Horn Assembly - 566 (.157)
	14789	Hose & Horn Assembly - 567, 568, 569, 584 (.312)
	14947	Hose & Horn Assembly - 589 (.213)
	14948	Hose & Horn Assembly - 591 (.180)
	3A	14778
14871		Strap & Clip Assembly (Black Plastic) 1/2" Hose 30 lb.
4	06978	Hose Gasket (O-Ring)
5	00160	Ring, Pin Stainless Steel
6	00532	Chain (Nylon) for Ring Pin
7	01387	Lock Wire Seal (Yellow)
8	09584	Hanger Loop with Screw
9	09840	Lever & Rivet - ALL MODELS
9A	01563	Rivet Only for Lever
10	09020	Handle & Rivets - ALL MODELS
10A	01564	Rivets Only for Handle (2 Required)
11	05225	Gauge - 240 PSI
12	09102	Gauge Guard, Chrome Plated Brass
13	06093	Valve Stem Assembly
14	00383	Spring
15	01700	Downtube/Retainer Ass'y - 6kg (13.2 lb.)
	01667	Downtube/Retainer Ass'y - 20 lb.
	09583	Downtube/Retainer Ass'y - 30 lb.
16	12383	Protective Foot Ring for Bottom of Cylinder 7" DIA - 20lb. & 6kg. (13.2lb.)
	12952	Protective Foot Ring for Bottom of Cylinder 8" DIA - 30lb.
17	23504	Nameplate 592, 594
	23505	Nameplate 595, 599
	23506	Nameplate 564, 581
	23507	Nameplate 566, 580, 584
	23508	Nameplate 582
	23509	Nameplate 567, 589
	23510	Nameplate 569, 591
	23511	Nameplate 568
All Valve Assemblies include Valve Body, Gauge, Gauge Guard, Hanger Loop, Lever and Handle		

* Nameplates do not include UL and USCG Listing.

* Hose assemblies for older extinguishers utilizing a swivel type connector are no longer available. Order valve assembly 14874 and hose listed above for that model.