



PARTS LIST

for

1 - 5 lb. Dry Chemical (Fixed Nozzle)

Aluminum Valve Models

- | | |
|-------------------------|----------------------|
| A620 - 1lb. REG | A/B410 - 2 1/2lb. PK |
| 417 - 2 1/2lb. ABC | 425 - 5lb. ABC |
| A/B417 - 2 1/2lb. ABC | 409 - 5lb. REG |
| 403 - 2 1/2lb. REG | A/B409 - 5lb. REG |
| A/B/C403 - 2 1/2lb. REG | 416 - 5lb. PK |
| 410 - 2 1/2lb. PK | A/B416 5lb. PK |

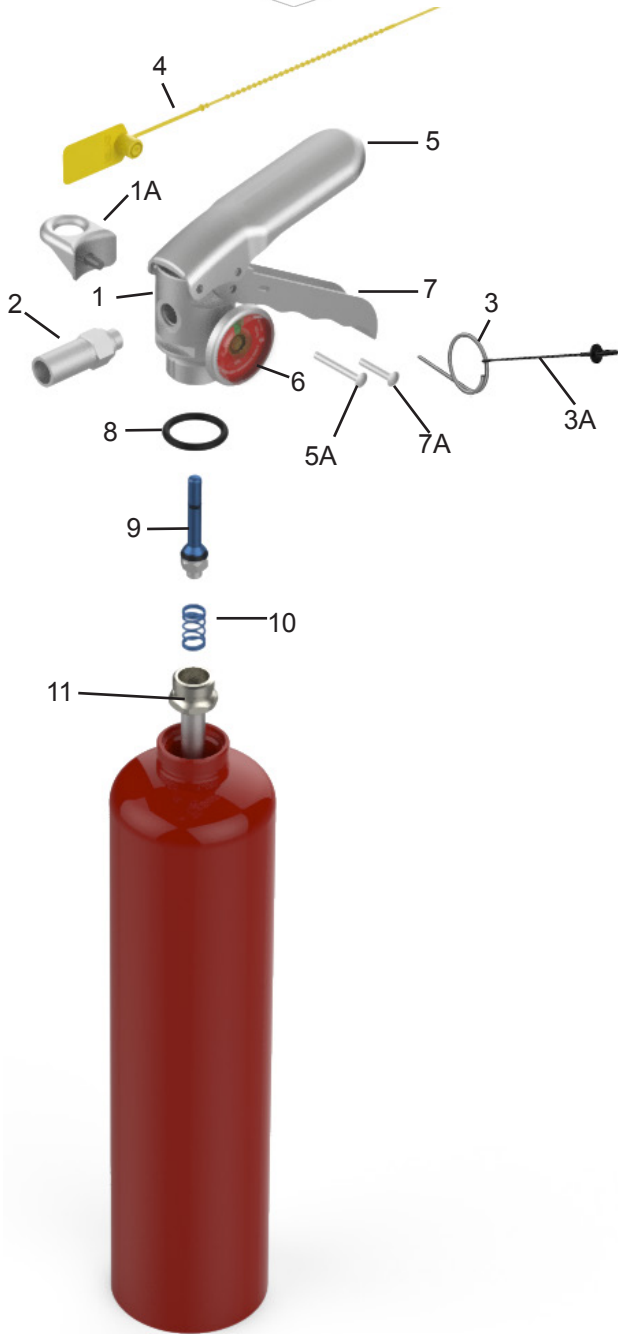

ITEM NO.	PART NO.	DESCRIPTION
1	12699	Modified Valve Assembly
	11823	Standard Valve Assembly
1A	14220	Hanger Loop w/Screw
2	12494	Nozzle - A620 (.076 SHORT)
	01926	417, A/B417 (.129)
	03741	409, A/B409, 416, A/B416 (.173P)
	03211	403, A/B/C 403 (.120ST)
	01276	410, A/B410 (.120)
3	00160	Ring Pin
	16268	Ring Pin 1 lb. & 2 1/2 lb.
3A	00532	Chain (Nylon) for Ring Pin
4	01387	Lock Wire Seal (Yellow)
5	11825	Lever & Rivet
5A	01060	Rivet Only for Lever All Valves
5B	02625	Lever & Rivet - MODIFIED VALVE
6	08184	Gauge - 100 PSI for A620
	03103	Gauge - 195 PSI
7	11826	Handle & Rivet
7A	01064	Rivet Only for Handle - ALL VALVES
7B	09001	Handle & Rivet - MODIFIED VALVE
8	05241	Collar O-Ring
9	06092	Valve Stem Assembly
10	01074	Spring
11	06069	Downtube/Retainer Assembly - A620
	01075	417, A417, C403, 403, A403, 410, A410
	06212	409, A/B409, 425, 416, A/B416, B403, B410, B417
ALL BRACKETS - SEE BRACKET PAGE		
ALL FILL & HYDROTEST ADAPTERS - SEE ADAPTERS PAGE		
All Valve Assemblies include Valve Body, Gauge, Lever and Handle (Loop and Screw on 11823)		